

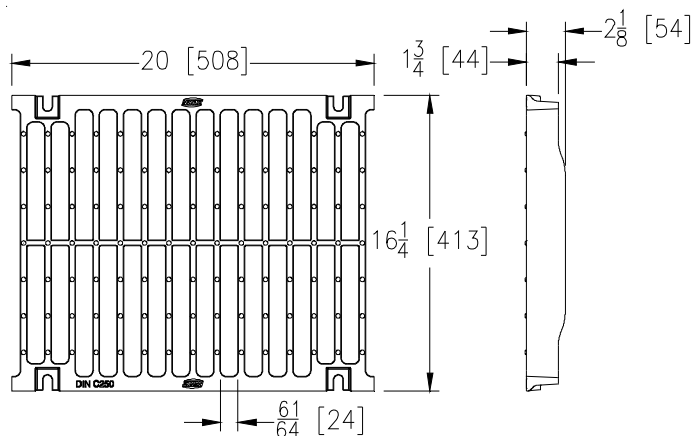

Z874-12

12" WIDE THROAT GRATES

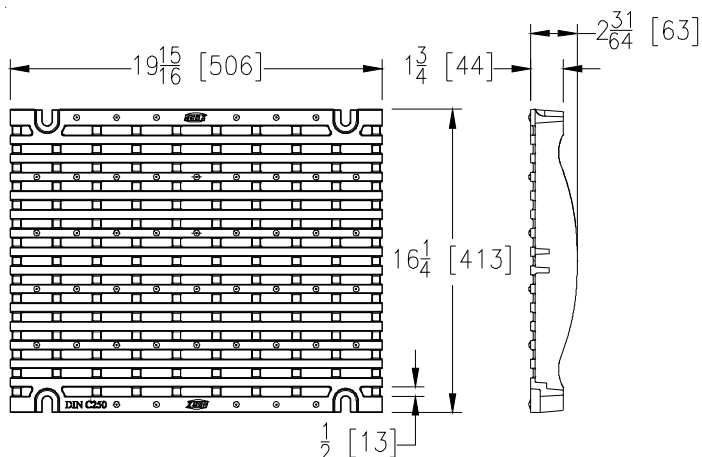

Please Check	Item No.	ADA-USA Domestic Ductile ADA Compliant		
✓	9	Material: Ductile Iron		
		DIN Rating: Class C		
		Weight: 26.50 # per ft.		
		Open Area: 66 sq. in. per ft.		
		ANSI Rating: Heavy-Duty		
		Application: Roadway, ADA		
		Slot Width/Hole Size: .5"		
		ADA	H-20	FAA
		Yes	Yes	No

Please Check	Item No.	DGC-USA -Domestic Ductile Iron Slotted		
✓	10	Material: Ductile Iron		
		DIN Rating: Class C		
		Weight: 29.00 # per ft.		
		Open Area: 118 sq. in. per ft.		
		ANSI Rating: Heavy-Duty		
		Application: Heavy Vehicle & Truck		
		Slot Width/Hole Size: .95"		
		ADA	H-20	FAA
		No	Yes	No

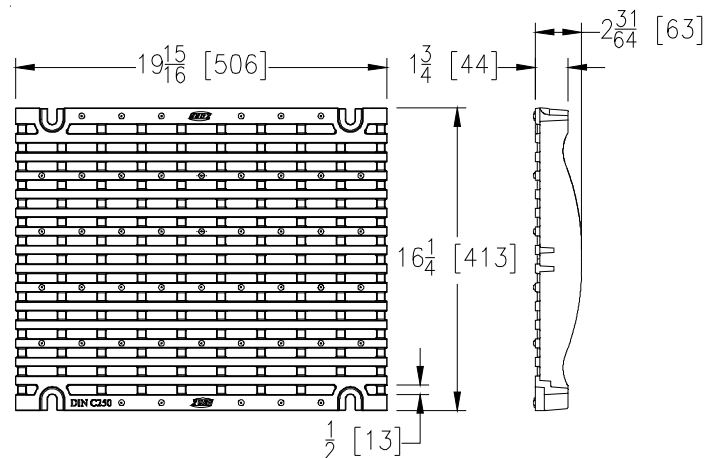
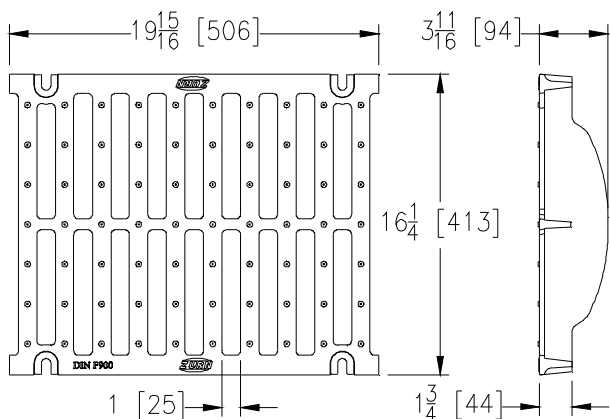

Please Check	Item No.	DGF-USA -Domestic Ductile Iron Slotted		
✓	11	Material: Ductile Iron		
		DIN Rating: Class F		
		Weight: 39.8 # per ft.		
		Open Area: 120 sq.in.per ft.		
		ANSI Rating: Heavy-Duty		
		Application: Heavy Vehicle & Truck		
		Slot Width/Hole Size: 1"		
		ADA	H-20	FAA
		No	Yes	Yes

Please Check	Item No.	GADA-USA -Galvanized Domestic Ductile ADA Compliant		
✓	12	Material: Ductile Iron		
		DIN Rating: Class C		
		Weight: 26.50 # per ft.		
		Open Area: 66 sq. in. per ft.		
		ANSI Rating: Heavy-Duty		
		Application: Roadway, ADA		
		Slot Width/Hole Size: .5"		
		ADA	H-20	FAA
		Yes	Yes	No